

LA GUILLOTINE



To download the latest version of the users manual, please log on to your customer account [on our website](http://www.australiapianosupply.com.au), click on My Account then Downloads.

www.australiapianosupply.com.au

GENERAL NOTES :

* This felt cutter was specifically designed to cut piano felts and leathers and was only tested for such purpose. Any other usage is left at the user's risks and discretion.

* Be careful not to over tighten any of the screws or you could damage your felt cutter.

Maximum torque for side and back guides: M6=0.8N.m

Maximum torque for the metal rods : M5=1.5N.m

Maximum torque for the bearings and blade locker : M4=1.5N.m

* Parts subject to wear and tear : the springs will eventually need changing as repeated compression will wear them out. The blade also needs changing to ensure clean cuts.

SAFETY:

! This felt cutter should **ONLY** be used with the magnetic safety block on. When the safety block is taken off, the provided blade protector should be used to cover the blade. Only one person at a time should operate this felt cutter and both hands of the operator should either be, or none be, on the handle at all time. Never leave your fingers under the safety block when operating, this felt cutter is very sharp. Australia Piano Supply declines all responsibility in the event of an accident.

ASSEMBLY INSTRUCTIONS :

The whole assembly process should be smooth and easy. Be careful not to cross thread or overtighten any of the screws.

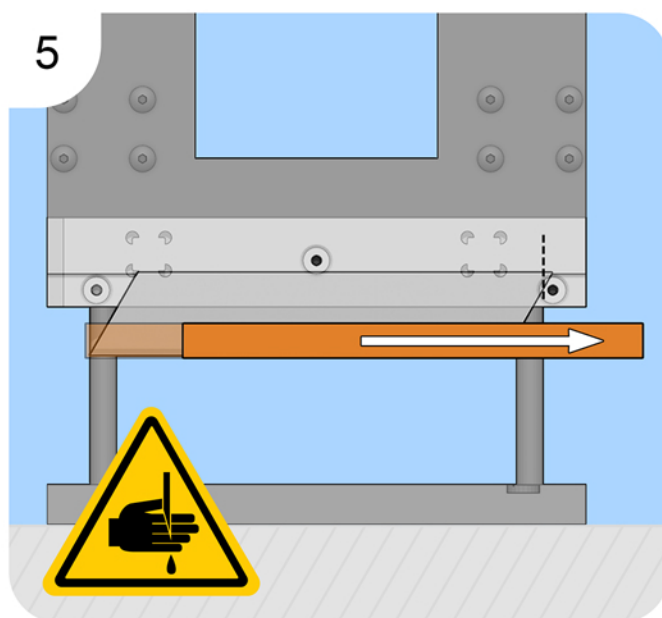
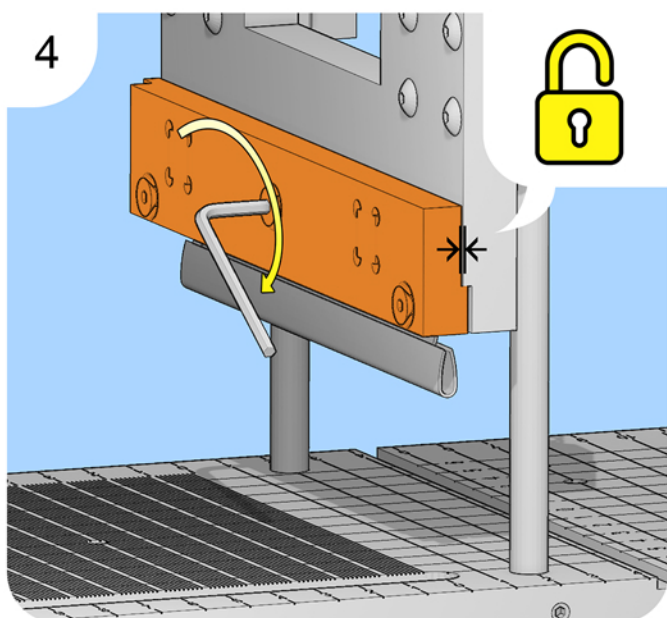
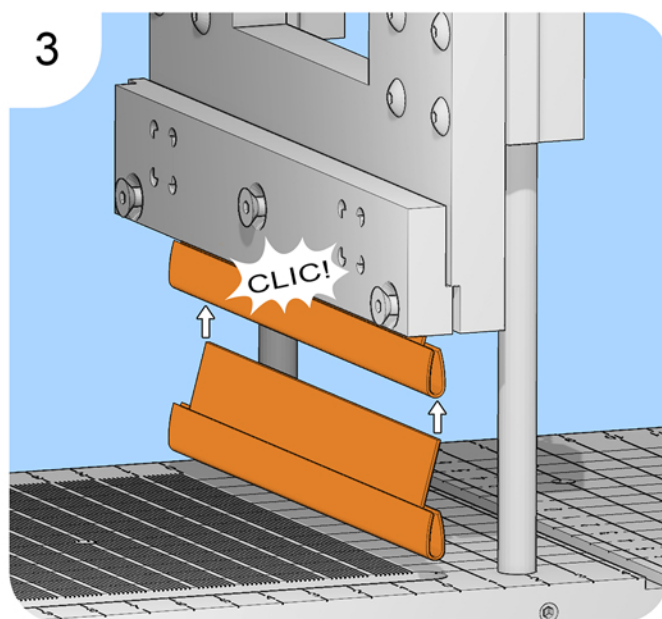
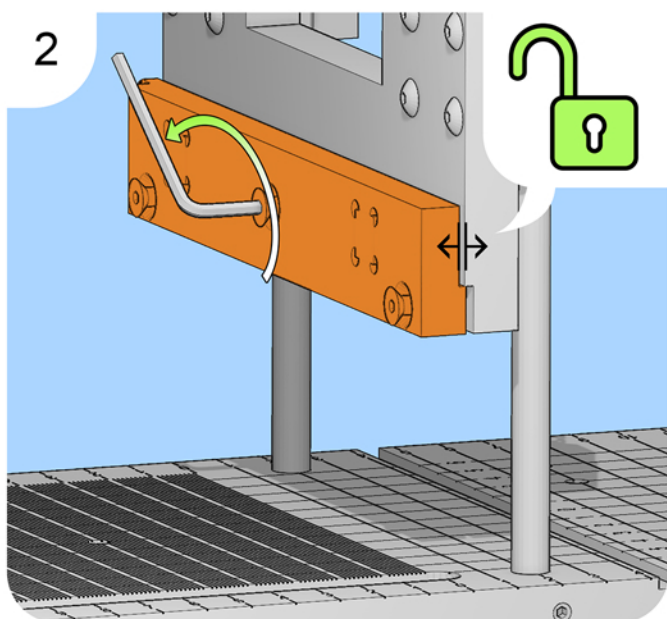
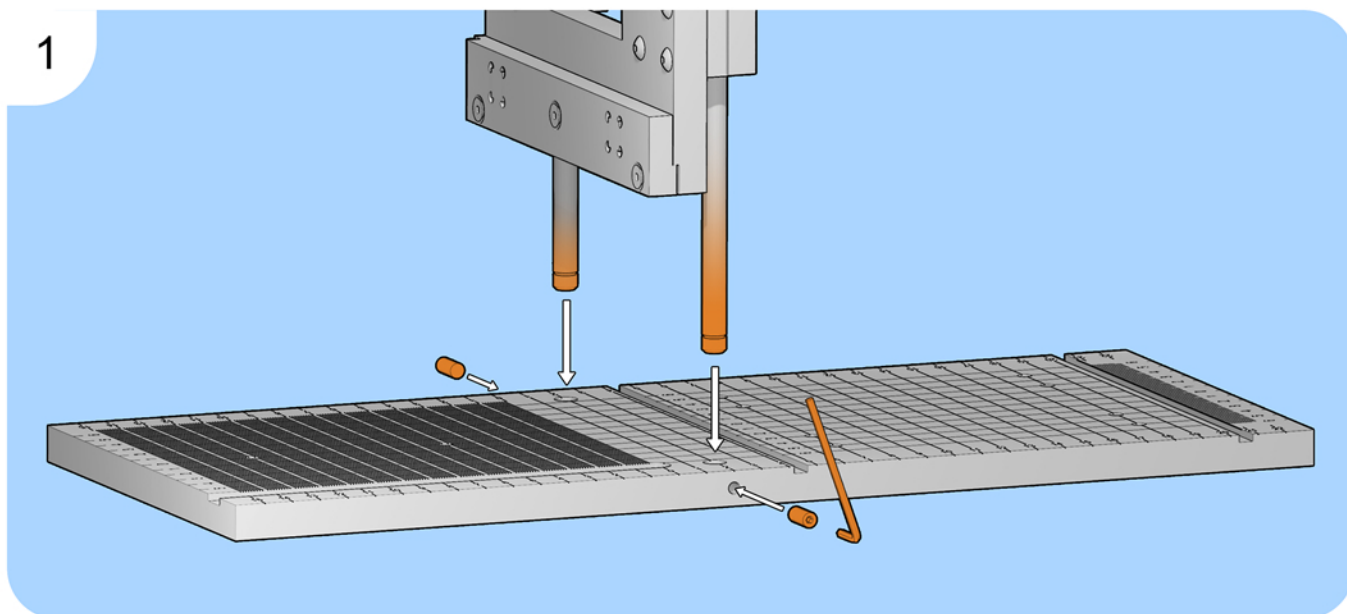

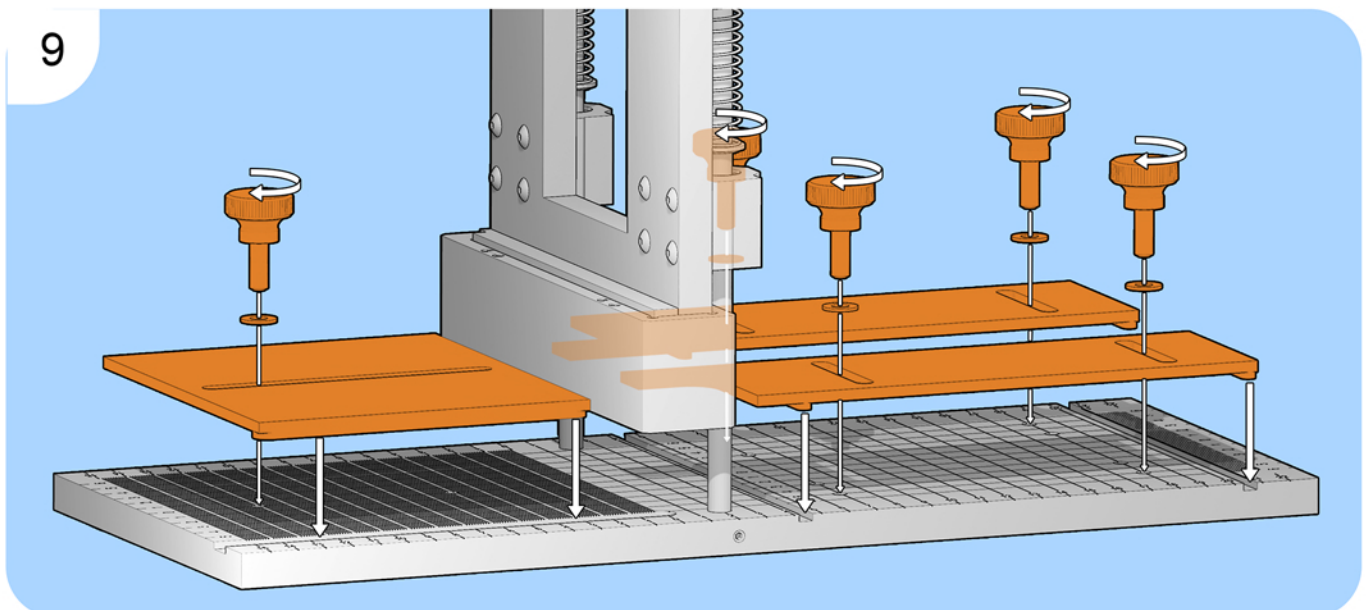
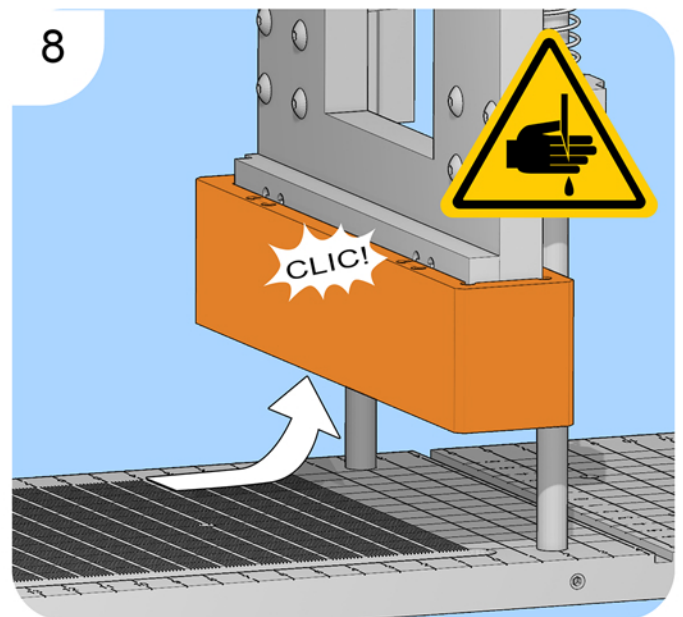
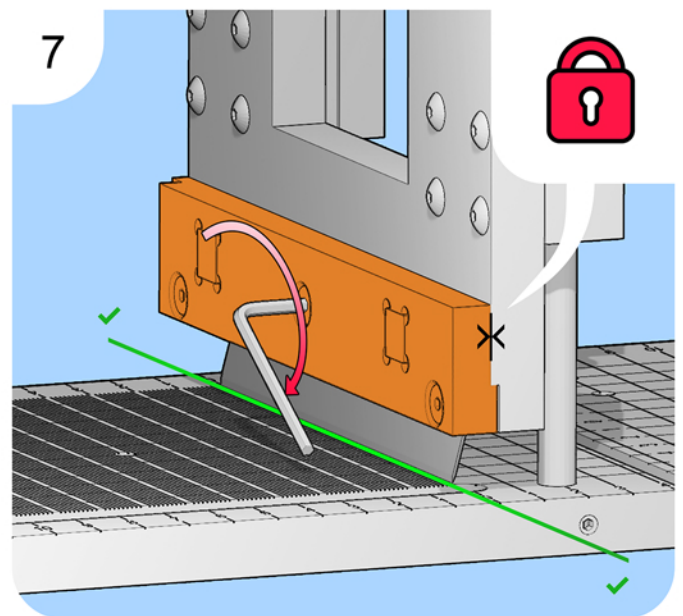
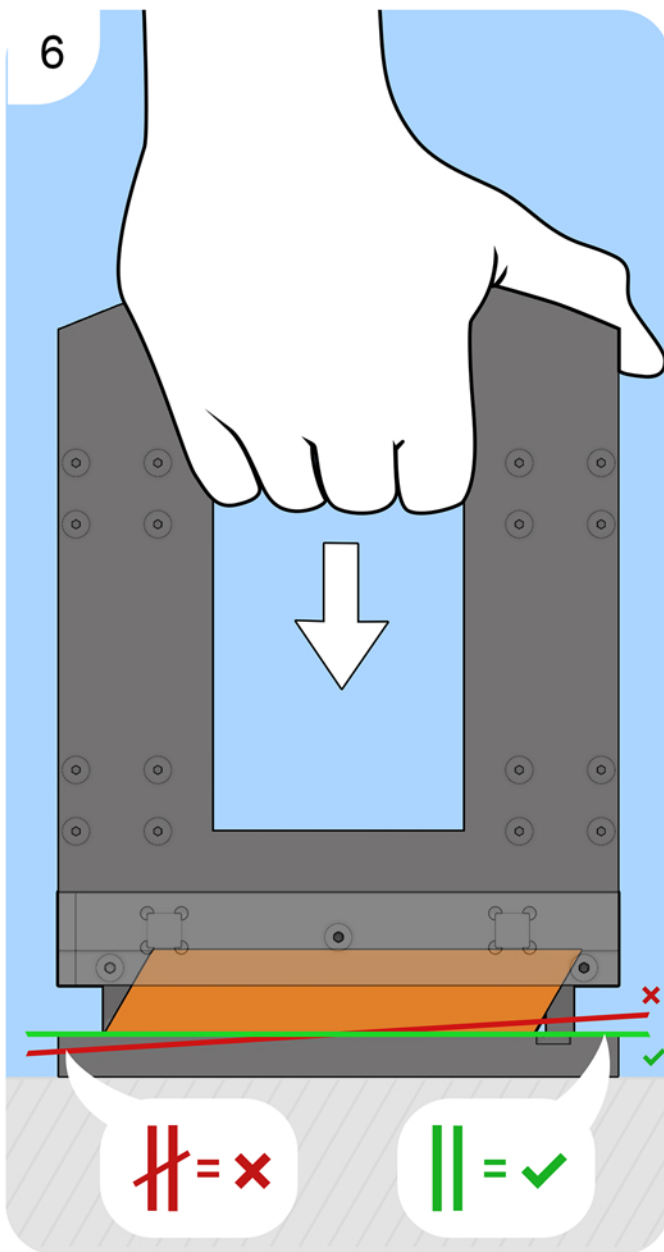

TO CHANGE THE BLADE:

- remove the **safety block**.
- cover the old **blade** with its original **blade protector**.
- slightly undo the **blade locker screws** to free and remove the blade (step 2).
- cover the new blade with the **blade protector** and insert it in the magnetic **blade locker** slot.
- refer to the above Assembly Instructions and repeat steps 4 to 8.

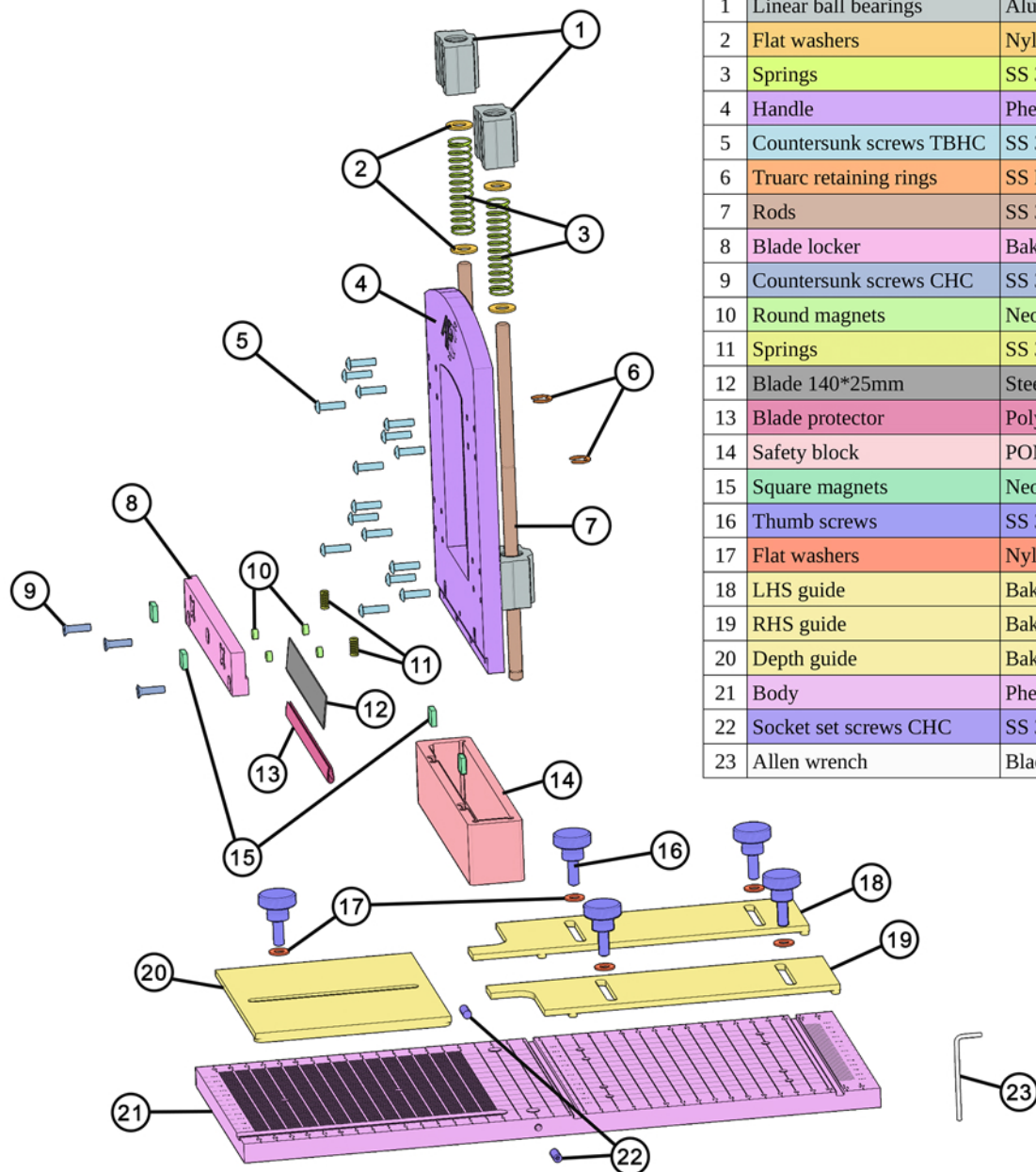

#	Designation	Material (main)	Qty
1	Linear ball bearings	Aluminium	4
2	Flat washers	Nylon	4
3	Springs	SS 302	2
4	Handle	Phenolic cotton cloth	1
5	Countersunk screws TBHC	SS 304	16
6	Truarc retaining rings	SS DIN571	2
7	Rods	SS 304	2
8	Blade locker	Bakelite	1
9	Countersunk screws CHC	SS 316	3
10	Round magnets	Neodymium	4
11	Springs	SS 302	2
12	Blade 140*25mm	Steel	1
13	Blade protector	Polyethylene	1
14	Safety block	POM	1
15	Square magnets	Neodymium	4
16	Thumb screws	SS 304	5
17	Flat washers	Nylon	5
18	LHS guide	Bakelite	1
19	RHS guide	Bakelite	1
20	Depth guide	Bakelite	1
21	Body	Phenolic cotton cloth	1
22	Socket set screws CHC	SS 304	2
23	Allen wrench	Black steel	1

CARE:

* We advise you regularly use a drop of liquid piano action lubricant (type CLP) on the metal rods to keep the felt cutter in a good condition.

* You should keep the felt cutter clean, especially the metal rods and the safety block. Every now and then it would be a good idea to dismantle the handle from the base (via the two metal rods lock screws) to wipe them clean before reassembly. We recommend using compressed air on all parts after use, to keep the tool free of felt dust. Remember to adjust the blade according to the assembly instructions after each reassembly.

ACCESSORIES:

APS can supply you with extra accessories for this felt cutter :

- thinner side and depth guides
- carbon blades (black, sharper, long lasting)

Visit our online store to find out more:

www.australiapianosupply.com.au

